



DEPLOYMENT ENHANCEMENT

SELECTIVE ROTATION TECHNOLOGY

PG 04

SPECIALITY DEPLOYMENT

PG 08

NO  
BARRIERS





## SELECTIVE ROTATION TECHNOLOGY

The **SwivelMASTER** is leading edge of the Selective Rotation Technologies, which allows the rotation of the upper portion of the string without rotation or torque being applied to the string below the tool.

## FEATURES

Conventionally, the SwivelMASTER is run in 'Swivel' mode, allowing the operator to engage upper string rotation when needed. The tool can be converted to a 'Locked' mode, by design, or for contingency reasons, during the operations.

The SwivelMASTER holds heavy duty compression & tension bearings, providing long liner deployment and pulling capabilities

Large ID

High torque capacity clutch in locked mode

Standard rotary connections

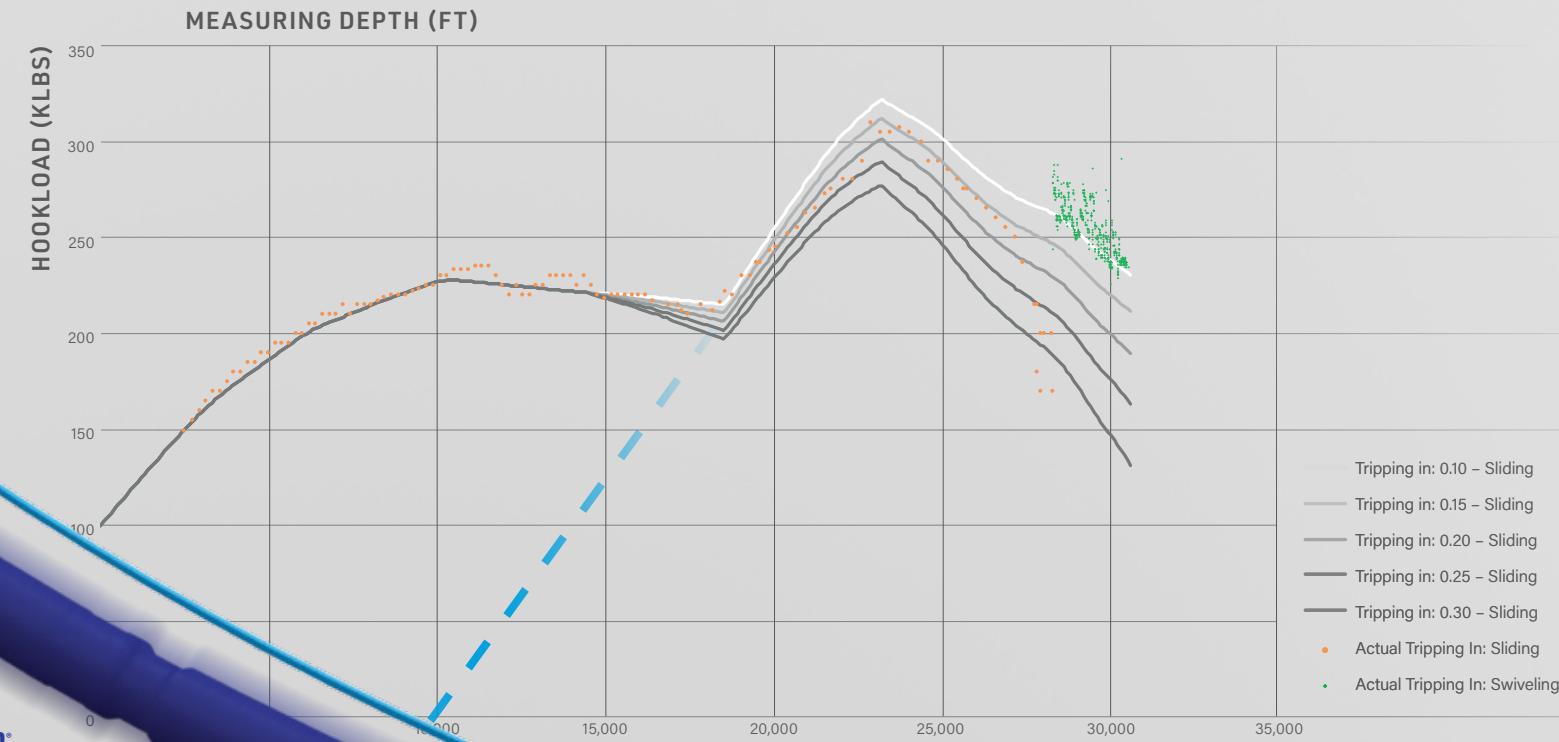

For over a decade, the SwivelMASTER has been used extensively in challenging ERD liners and completions deployment operations, mitigating excessive drag and hookload limitations, helical buckling, differential sticking, and providing additional available weight to unlock well design restrictions and overcome unexpected wellbore instabilities.

This challenging deployment (16,000ft , + of 6-5/8" pre-perforated liner including multiple swell packers) was initiated in conventional Slack-off mode. Actual Hookload point highlights smooth deployment down to 27,800ft. From that depth, unexpected severe hookload occurred, ultimately preventing any further progress and compromising the full well completion. Landing string rotation was then initiated, providing an additional 109 klbs of additional weight. Selective string rotation was maintained to successfully land the completion at Target Depth.

ROTATIONABILITY™

## SELECTIVE ROTATION TECHNOLOGY

The SwivelMASTER **MultiFunction (MF)** is a drill pipe deployed tool that can be run in either locked or swivel mode and is hydraulically converted by applying differential pressure.

The multiple conversion capability provided by the SwivelMASTER MF provides additional flexibility and operational efficiency when the successive sequences of deployment, tool activation and tool release require alternative optimum drag reduction and weight transmission (selective string rotation); followed by necessary torque or rotation transmission below the Swivel (tool orientation, activation, drilling, contingency release).

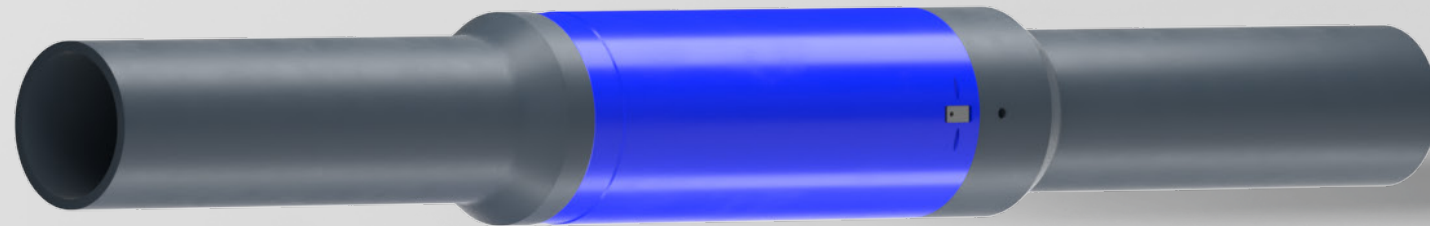
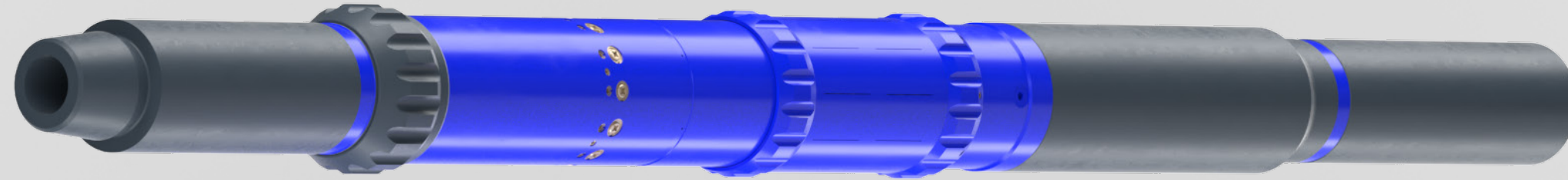
TERRASWIVELMULTIFUNCTION TOOL

Derived from the SwivelMASTER Technology, the **TerraSWIVEL** is a robust single mode technology, allowing the necessary rotation of the upper string to be isolated from the string below.

By reducing the frictional drag on the upper string, the TerraSWIVEL will facilitate the deployment of drill pipe conveyed logging tools in complex well geometries such as high inclination or long horizontal sections. In dedicated hole cleaning operations, the TerraSWIVEL allows high RPM to be applied on the upper string, while preserving sensitive equipment included in the lower string.



The **CasingSWIVEL** is a permanent addition to the casing or production liner string, enhancing and extending the well design capabilities in ERD and high step out wells.

Incorporated into production liners further down the string, the CasingSWIVEL allows substantial additional weight capability, which can be invested in extended reservoir exposition, or in avoiding multiple segmented liner runs. Included in intermediate or production casing strings, the CasingSWIVEL allows partial string rotation while ensuring torsional limits are not exceeded.

Reduces the recovery cost of a stuck in hole incident by increasing pulling capabilities

Provides an improved cement bond over the area that is rotating

Easy to deploy

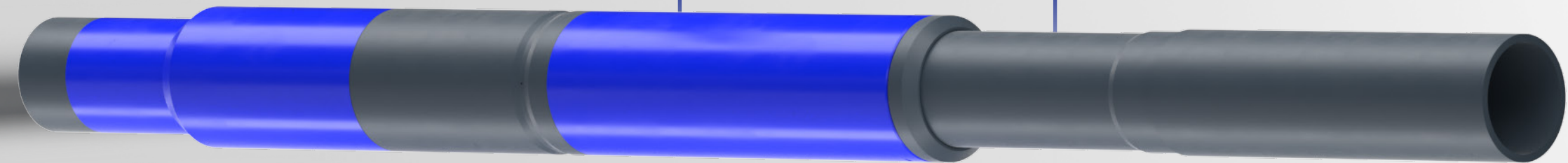
CASINGSWIVEL



## SPECIALITY DEPLOYMENT

**NaviSHOE** will improve the probability of casings and liners reaching TD when rotation cannot be applied.

Advanced casing shoe system allowing an eccentric nose to be gradually indexed through compression on the BHA, guiding and facilitating deployment across obstructions.

Can be used on cemented or uncemented casing strings, completions, liners and sand control screens

Supplied with customer specified casing connections

Drill out ID matches casing being run

Available in most standard casing/liner versus open-hole combinations

Strength to suit casing specifications

Available with a free-rotating shoe option

Flow by areas have been maximized for circulation and cementation

Continuous ratchet with higher strength than connection

Also available in a NaviREAM option

NAVIREAM

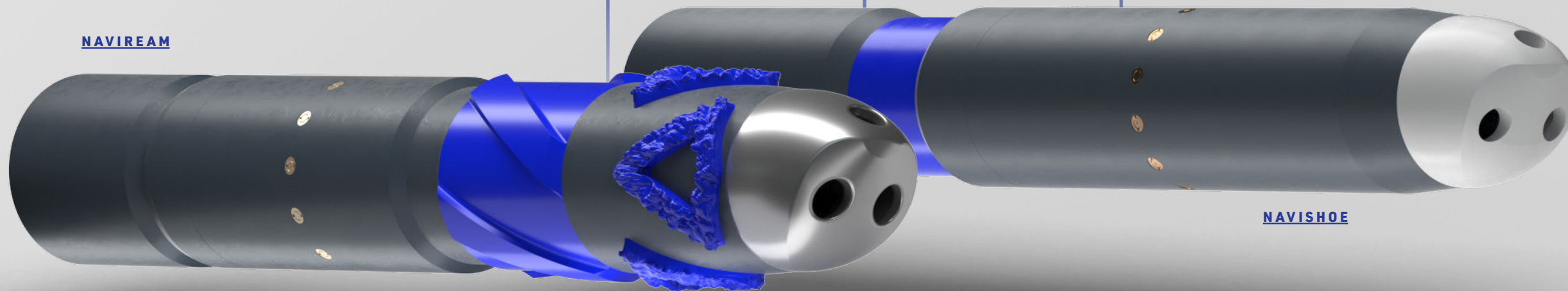

NAVISHOE

## SINGLE RUN MOTOR SYSTEMS

Working past ledges to avoid unnecessary NPT; the **SureREACH Motor System** is a low cost reaming method that is easy to use, not complicating the final string installation.

SureREACH Motor systems are designed to be run on the bottom of the final casing or liner string to ream or drill to planned TD through pumping only. The motor is available in a wide range of sizes, stages and rotor stator configurations to suit your applications.

## SureREACH Reamer

Used as part of the SureREACH Motor System, the SureREACH Reamer is a sacrificial eccentric nose reamer with a PDC cutting structure and TCI reaming/gauge protection. The tool reams and drills borehole variances without the risk of side tracking and is applied as an alternative to a conventional bit.

It can provide up to

**100 HOURS OF IN-WELL OPERATING USE,**  
requiring the same power output, OD and connections as a standard serviceable motor.

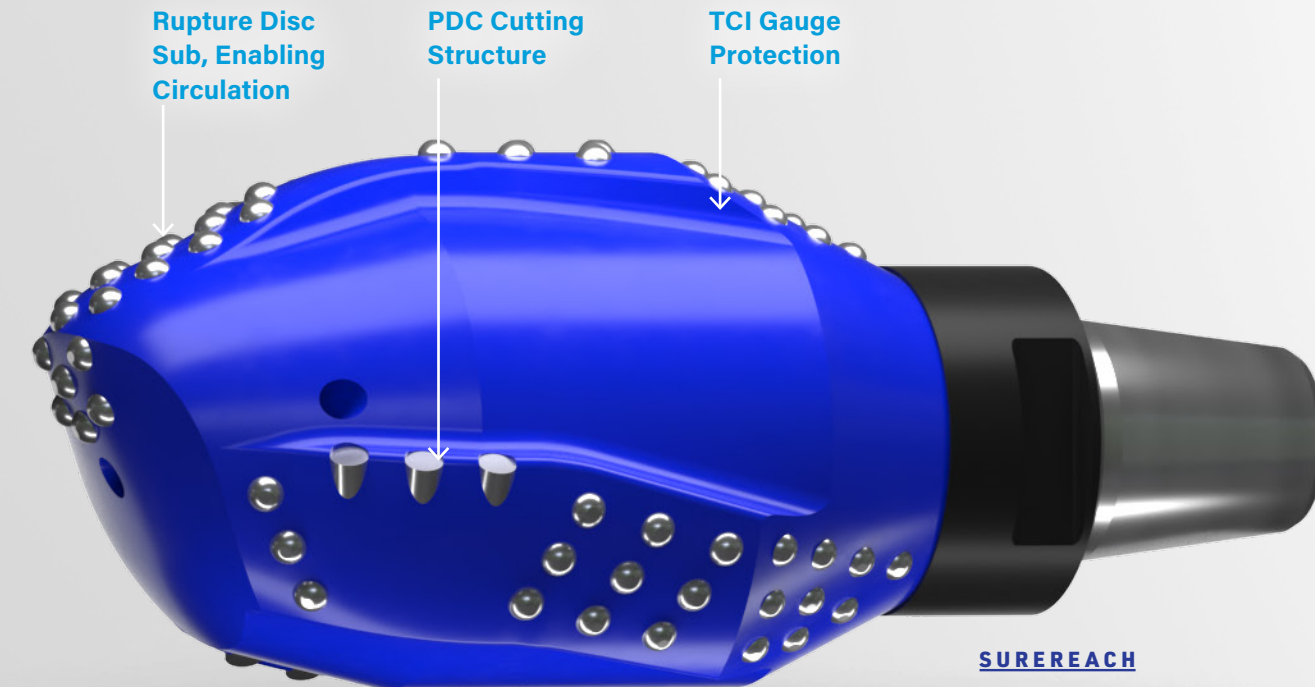

SUREREACH



**Innovex** engineering team is dedicated to developing and continually modifying our equipment to meet the evolving needs of the industry and our customers.

Our hands-on approach includes performing pre-run modeling and post-run analysis on many of our technologies. Our technical procedure analyzes the wellbore schematic and interacts with the drilling engineer. Innovex defines the general themes and operating practices in the specific drilling area, including bottomhole temperatures, expected mud weights, planned tops of cement, potential depleted zones and other influencing factors.

Innovex's focused applications and design engineers, research and development projects and testing initiatives effectively aid our customers in reaching TD safely and cost-effectively, achieving zonal isolation and establishing long-term wellbore integrity.

**TO LEARN MORE ABOUT OUR WELL  
SOLUTIONS ENGINEERING APPROACH  
VISIT OUR WEBSITE.**

**NO  
BARRIERS**



## NORTH AMERICA

### CORPORATE HEADQUARTERS

4310 North Sam Houston  
Parkway East  
Houston, TX 77032  
T: +1 346 398 0000  
E: sales@innovex-inc.com

### EAST TEXAS & LOUISIANA

1138 West Harrison Road  
Longview, TX 75604  
T: +1 903 759 2800

2212 Highway 662 N  
Building C  
Amelia LA 70340  
T: +1 985 412 4980

### FISHING TOOLS

1519 S. Flournoy Road  
Alice, TX 78332  
T: +1 361 396 0139

10938 Lucerne Street  
Houston, TX 77016  
T: +1 281 219 6613

601 McDonald Street  
Odessa, TX 79761  
T: +1 432 580 7414

1034 Forum Drive  
Broussard, LA 70518  
T: +1 337 492 5228

118 Common Court  
Houma, LA 70360  
T: +1 985 868 7333

2415 2nd Ave West  
Williston, ND 58801  
T: +1 701 572 0565

1294 South 1500 East  
Vernal, UT 84078  
T: +1 435 781 2856

### SOUTH TEXAS

5746 Leopard Street  
Corpus Christi, TX 78408  
T: +1 361 452 2771

178 Oil Road  
Pleasanton, TX 78064  
T: +1 830 401 5887

### MIDCONTINENT

17712 W. Hwy 33  
Cashion, OK 73016  
T: +1 832 775 9140

2709 S. Ann Arbor Ave  
Oklahoma City, OK 73128  
T: +1 405 491 2658

### NORTHEAST

1848 Old Route 33  
Weston, WV 26452  
T: +1 304 841 0821

109 N. Madison Ave  
Grove City, PA 16127  
T: +1 724 605 1397

### PERMIAN BASIN

9513 W. County Road 143  
Midland, TX 79706  
T: +1 979 314 3764

3111 W. 114th  
Levelland, TX 79336  
T: +1 806 215 7960

5910 S. County Road 1270  
Midland, TX 79706  
T: +1 432 999 4013

651 McDonald Street  
Odessa, TX 79761  
T: +1 918 445 0588

### ROCKIES | BAKKEN

13 Town & County Lane  
Williston, ND 58802  
T: +1 701 353 3334

480 Basher Drive  
Berthoud, CO 80513  
T: +1 720 552 9982

600 17th Street, Suite  
2800 South Tower  
Denver, CO 80202  
T: +1 601 218 3728

### CANADA

Suite 1430, 250 6th Ave SW  
Calgary, AB, Canada  
T2P 3H7  
T: +1 403 969 1415

4116-51 Avenue NW  
Edmonton, Alberta,  
Canada T6E 5V8  
T: +1 780 433 9957  
F: +1 780 472 2351

7720-17 Street  
Edmonton, AB, Canada  
T6P 1S7  
T: +1 780 440 4440

## LATIN AMERICA

### MEXICO

Mexico City, Mexico  
T: +52 55 5545 8111  
M: +52 1 55 2668 1760

Carretera Villahermosa – Cárdenas Km 5.5,  
Bodega M1L6B2, Interior Parque Logístico  
Industrial Tabasco, Ria. Anacleto Canabal  
4ta sección, Centro Tabasco, 86287  
T: +52 9933 168887

### COLOMBIA

Kra 100 No. 25 C 11 Bd 7,  
Centro empresarial  
Omega  
Bogota, Columbia CP 110911  
T: +57 1 756 1920

### ARGENTINA

Espana 337 Cipolletti, Argentina  
Luis Beltran 367 Neuquen, Argentina  
T: +54 911 5643 4197

## MIDDLE EAST & ASIA

### UNITED ARAB EMIRATES

Office 2109, Jumeirah  
Bay X3 Tower  
Cluster X, Jumeirah Lake Towers, Dubai, UAE  
PO BOX 333648  
T: +971 4 454 8616

### SAUDI ARABIA

7958 Abu Al Husan Al Zahrawy St.  
Al Khalidiyah Ash Shamaliyah, Dammam  
32231 3257  
T: +966 13 814 6662

### SULTANATE OF OMAN

Warehouse # 160Z, BBH Logistics City  
Rusayl Industrial Area, Muscat,  
Sultanate of Oman  
T: +968 225070199

## EUROPE, CASPIAN & AFRICA

### SCOTLAND

1 Minto Place  
Altens Industrial Estate, Aberdeen, Scotland  
AB12 3SN  
T: +44 1224 659 000

FOR ALL LOCATIONS PLEASE VISIT THE  
LOCATIONS PAGE ON [OUR WEBSITE](#).