

## PRODUCT LINE

Fishing & Intervention | Junk Catchers

## PRODUCT

Fishing Magnets



### OVERVIEW

The Logan Fishing Magnet is designed to retrieve small metal, oddly shaped objects such as milling shavings, bit cones, cutters, bearings, slips, tong pins, and hand tools from the bottom of the well bore. Typically, these objects are the result of bit failures, an accumulation of mill cuttings, or simply accidental droppings of unmillable objects. In almost all of these cases, the fish cannot be engaged in the normal manner. Fishing magnets successfully remove these objects from the hole. The tool's design features generous circulation ports that wash away cuttings and other debris that might interfere with or prevent contact with the magnet. A variety of guides are available to accommodate any retrieval situation.

### CONSTRUCTION

The Logan Fishing Magnet Assembly consists of a body, integral housing, integral pole plate, magnet element, and standard flush guide. The body is manufactured from high strength alloy steel. It has a tool joint pin top connection and generous circulation ports.

The magnet element is the most efficient and powerful permanent magnet available. The magnet can be recharged if necessary.

The magnet body, housing, and pole plate are threaded and welded together during assembly with the magnet element in place.

The standard flush bottom guide is threaded and easily removed. Lipped guides and mill guides are also available.

### OPTIONAL ACCESSORIES

#### Guides

A flush guide is standard. Lipped guides and mill guides are also available. The lipped guide centralizes the fish to assure contact with the magnet. The mill guide enables milling of any soft formation or settling to free debris at the bottom of the hole.

#### Keepers

While magnets should not lose their strength during normal use, storing the magnet in the vicinity of an electric motor or bringing magnets too close to each other can adversely affect their charge. Keepers are recommended when storing magnets to reduce the attraction of miscellaneous metal objects or particles. A keeper is required for shipment via air freight.

#### Magnet Chargers

Recharging is quick and easy with our state-of-the-art control console. There is no limit to the number of times a magnet can be recharged. Logan Magnet Chargers ensure maximum charging efficiencies with ease of operation and long-life durability.

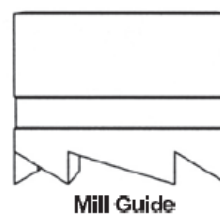
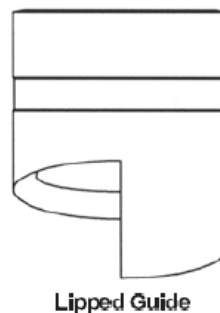
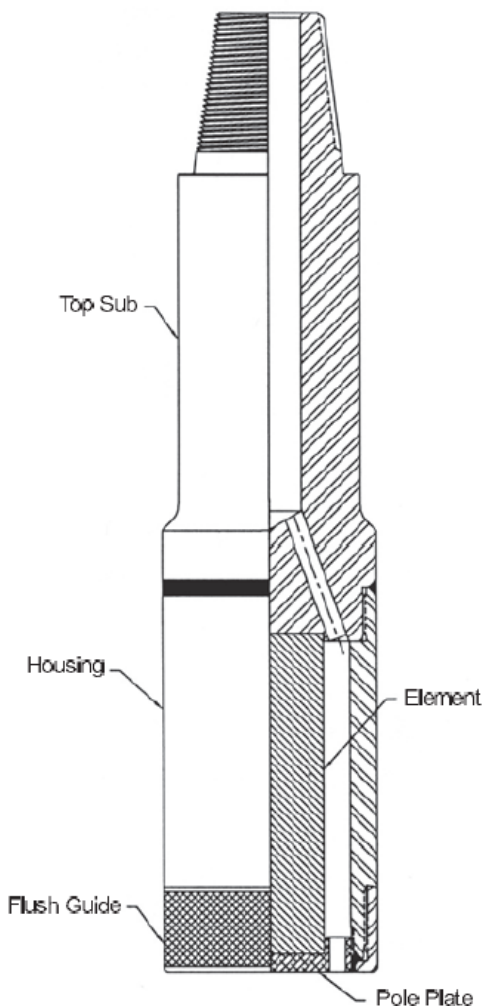

**PRODUCT LINE**

Fishing & Intervention | Junk Catchers

**PRODUCT**

Fishing Magnets



Hole Size		1-1/4 to 2	1-5/8 to 2-1/2	2 to 2-3/4	2-3/8 to 3-1/4	2-3/4 to 3-5/8	3 to 3-3/4	3-1/4 to 4-1/8
OD of Body		1	1-1/4	1-1/2	1-3/4	2-1/4	2-1/2	3
Top Connection		5/8-11 UNC	5/8 SR	5/8 SR	3/4 SR	3/4 SR	3/4 SR	2-3/8 Tbg
Approx. Pull in lbs		5 to 7	8 to 10	11 to 14	15 to 20	25 to 50	50 to 85	85 to 190
<b>Complete Assembly</b>	<b>Logan Part No.</b>	<b>306-100</b>	<b>306-125</b>	<b>306-150</b>	<b>306-175</b>	<b>306-225</b>	<b>306-250</b>	<b>306-300</b>
	Bowen No.	32060	32080	32100	32120	32150	32170	32180
Body	<b>Logan Part No.</b>	-	<b>V1000</b>	<b>V1001</b>	<b>V1002</b>	<b>V1003</b>	<b>V1004</b>	<b>V1005</b>
	Bowen No.	-	32081	32101	32121	32151	32171	32180
Housing	<b>Logan Part No.</b>	<b>V20005</b>	<b>V2000</b>	<b>V2001</b>	<b>V2002</b>	<b>V2003</b>	<b>V2004</b>	<b>V2005</b>
	Bowen No.	32062	32082	32102	32122	32152	32172	32182
Pole Plate	<b>Logan Part No.</b>	<b>V30005</b>	<b>V3000</b>	<b>V3001</b>	<b>V3002</b>	<b>V3003</b>	<b>V3004</b>	<b>V3005</b>
	Bowen No.	32063	32083	32103	32123	32153	32173	32183
Magnetic Element	<b>Logan Part No.</b>	<b>V4000</b>	<b>V4000</b>	<b>V4001</b>	<b>V4002</b>	<b>V4003</b>	<b>V4004</b>	<b>V4005</b>
	Bowen No.	32064	32084	32104	32124	32154	32174	32184
Flush Guide	<b>Logan Part No.</b>	-	<b>V6000</b>	<b>V6001</b>	<b>V6002</b>	<b>V6003</b>	<b>V6004</b>	<b>V6005</b>
	Bowen No.	-	32085	32105	32125	32155	32175	32185
Lifting Cap	<b>Logan Part No.</b>	-	-	-	-	-	-	-
	Connection	-	-	-	-	-	-	-
<b>Optional Components</b>								
Cut-Lipped Guide	<b>Logan Part No.</b>	-	<b>V6000</b>	<b>V6001</b>	<b>V6002</b>	<b>V6003</b>	<b>V6004</b>	<b>V6005</b>
	Bowen No.	-	32085	32105	32125	32155	32175	32185
Mill Guide	<b>Logan Part No.</b>	-	<b>V6000</b>	<b>V6001</b>	<b>V6002</b>	<b>V6003</b>	<b>V6004</b>	<b>V6005</b>
	Bowen No.	-	32085	32105	32125	32155	32175	32185
Adapter – 5/8" Sucker Rod	<b>Logan Part No.</b>	-	-	-	-	-	-	-
	Bowen No.	-	-	-	-	-	-	-
Adapter – 3/4" Sucker Rod	<b>Logan Part No.</b>	-	-	-	-	-	-	-
	Bowen No.	-	-	-	-	-	-	-
Keeper	<b>Logan Part No.</b>	<b>V90005</b>	<b>V9000</b>	<b>V9001</b>	<b>V9002</b>	<b>V9003</b>	<b>V9004</b>	<b>V9005</b>
	Bowen No.	-	66005	66008	74731	74732	66014	71716

Innovex reserves the right to change or discontinue designs without prior notice.

Note: Guides left oversized are extra charge. Magnets shipped via air freight must include a Keeper.

**When ordering, please specify:**

Name and number of assembly

Size – OD

Top Connection – if other than standard

**Recommended Spare Parts:**

1 x Lipped Guide

1 x Mill Guide



**PRODUCT LINE**

Fishing & Intervention | Junk Catchers

**PRODUCT**

Fishing Magnets



Hole Size		4 to 4-1/4	4-1/4 to 4-1/2	4-1/2 to 5	5-1/8 to 5-1/2	5-5/8 to 6	6-1/8 to 6-1/2	6-1/8 to 6-1/2
OD of Body		3-1/4	3-1/2	4	4-1/2	5	5-1/2	5-3/4
Top Connection		2-3/8 Tbg	2-3/8 API Reg	2-3/8 API Reg	2-7/8 API Reg	2-7/8 API Reg	3-1/2 API Reg	3-1/2 API Reg
Approx. Pull in lbs		85 to 190	150 to 250	175 to 250	250 to 320	320 to 385	385 to 425	385 to 425
<b>Complete Assembly</b>	<b>Logan Part No.</b>	<b>306-325</b>	<b>306-350</b>	<b>306-400</b>	<b>306-450</b>	<b>306-500</b>	<b>306-550</b>	<b>306-575</b>
	Bowen No.	32190	32210	32230	32240	32260	32270	32280
Body	<b>Logan Part No.</b>	<b>V1006</b>	<b>V1007</b>	<b>V1008</b>	<b>V1009</b>	<b>V1010</b>	<b>V1011</b>	<b>V1012</b>
	Bowen No.	32191	32211	32231	32241	32261	32271	32281
Housing	<b>Logan Part No.</b>	<b>V2006</b>	<b>V2007</b>	<b>V2008</b>	<b>V2009</b>	<b>V2010</b>	<b>V2011</b>	<b>V2012</b>
	Bowen No.	32192	32212	32232	32242	32262	32272	32282
Pole Plate	<b>Logan Part No.</b>	<b>V3006</b>	<b>V3007</b>	<b>V3008</b>	<b>V3009</b>	<b>V3010</b>	<b>V3011</b>	<b>V3012</b>
	Bowen No.	32193	32213	32233	32243	32263	32273	32283
Magnetic Element	<b>Logan Part No.</b>	<b>V4006</b>	<b>V4007</b>	<b>V4008</b>	<b>V4009</b>	<b>V4010</b>	<b>V4011</b>	<b>V4012</b>
	Bowen No.	32194	32214	32234	32244	32264	32274	32274
Flush Guide	<b>Logan Part No.</b>	<b>V6006</b>	<b>V6007</b>	<b>V6008</b>	<b>V6009</b>	<b>V6010</b>	<b>V6011</b>	<b>V6012</b>
	Bowen No.	32195	32215	32235	32245	32265	32275	32285
Lifting Cap	<b>Logan Part No.</b>	-	<b>V8000</b>	<b>V8000</b>	<b>V8001</b>	<b>V8001</b>	<b>V8002</b>	<b>V8002</b>
	Connection	-	2-3/8 API Reg	2-3/8 API Reg	2-7/8 API Reg	2-7/8 API Reg	3-1/2 API Reg	3-1/2 API Reg
<b>Optional Components</b>								
Cut-Lipped Guide	<b>Logan Part No.</b>	<b>V6006</b>	<b>V6007</b>	<b>V6008</b>	<b>V6009</b>	<b>V6010</b>	<b>V6011</b>	<b>V6012</b>
	Bowen No.	32195	32215	32235	32245	32265	32275	32285
Mill Guide	<b>Logan Part No.</b>	<b>V6006</b>	<b>V6007</b>	<b>V6008</b>	<b>V6009</b>	<b>V6010</b>	<b>V6011</b>	<b>V6012</b>
	Bowen No.	32195	32215	32235	32245	32265	32275	32285
Adapter – 5/8" Sucker Rod	<b>Logan Part No.</b>	-	-	<b>V5008</b>	<b>V5009</b>	<b>V5009</b>	<b>V5011</b>	<b>V5011</b>
	Bowen No.	-	-	62250	62252	62252	62254	62254
Adapter – 3/4" Sucker Rod	<b>Logan Part No.</b>	<b>V7005</b>	-	<b>V7008</b>	<b>V7009</b>	<b>V7009</b>	<b>V7011</b>	<b>V7011</b>
	Bowen No.	70513	-	62251	62253	62253	62255	62255
Keeper	<b>Logan Part No.</b>	<b>V9006</b>	<b>V9007</b>	<b>V9008</b>	<b>V9009</b>	<b>V9010</b>	<b>V9011</b>	<b>V9012</b>
	Bowen No.	66016	66021	66026	66027	66030	66031	74962

Innovex reserves the right to change or discontinue designs without prior notice.

Note: Guides left oversized are extra charge. Magnets shipped via air freight must include a Keeper.

**When ordering, please specify:**

Name and number of assembly

Size – OD

Top Connection – if other than standard

**Recommended Spare Parts:**

1 x Lipped Guide

1 x Mill Guide



**PRODUCT LINE**

Fishing & Intervention | Junk Catchers

**PRODUCT**

Fishing Magnets



Hole Size		6-5/8 to 7-1/2	7-5/8 to 8-1/2	8-5/8 to 9-3/4	9-7/8 to 11-5/8	10-1/2 to 11-7/8	11-3/4 to 13	12-1/4 to 14
OD of Body		6	7	8	9	10	10-1/2	11-1/2
Top Connection		3-1/2 API Reg	4-1/2 API Reg	4-1/2 API Reg	4-1/2 API Reg	6-5/8 API Reg	6-5/8 API Reg	6-5/8 API Reg
Approx. Pull in lbs		425 to 500	550 to 700	700 to 850	850 to 1,100	1,000 to 1,125	1,125 to 1,260	1,260 to 1,550
<b>Complete Assembly</b>	<b>Logan Part No.</b>	<b>306-600</b>	<b>306-700</b>	<b>306-800</b>	<b>306-900</b>	<b>306-1000</b>	<b>306-1050</b>	<b>306-1150</b>
	Bowen No.	32290	32300	32310	32330	32340	32350	32370
Body	<b>Logan Part No.</b>	<b>V1013</b>	<b>V1014</b>	<b>V1015</b>	<b>V1016</b>	<b>V1017</b>	<b>V1018</b>	<b>V1019</b>
	Bowen No.	32291	32301	32311	32331	32341	32351	32371
Housing	<b>Logan Part No.</b>	<b>V2013</b>	<b>V2014</b>	<b>V2015</b>	<b>V2016</b>	<b>V2017</b>	<b>V2018</b>	<b>V2019</b>
	Bowen No.	32292	32302	32312	32332	32342	32352	32372
Pole Plate	<b>Logan Part No.</b>	<b>V3013</b>	<b>V3014</b>	<b>V3015</b>	<b>V3016</b>	<b>V3017</b>	<b>V3017</b>	<b>V3019</b>
	Bowen No.	32293	32303	32313	32333	23243	32343	32373
Magnetic Element	<b>Logan Part No.</b>	<b>V4013</b>	<b>V4014</b>	<b>V4015</b>	<b>V4016</b>	<b>V4017</b>	<b>V4017</b>	<b>V4019</b>
	Bowen No.	32294	32304	32314	32334	32344	32344	32374
Flush Guide	<b>Logan Part No.</b>	<b>V6013</b>	<b>V6014</b>	<b>V6015</b>	<b>V6016</b>	<b>V6017</b>	<b>V6018</b>	<b>V6019</b>
	Bowen No.	32295	32305	32315	32335	32345	32355	32375
Lifting Cap	<b>Logan Part No.</b>	<b>V8002</b>	<b>V8003</b>	<b>V8003</b>	<b>V8003</b>	<b>V8004</b>	<b>V8004</b>	<b>V8004</b>
	Connection	3-1/2 API Reg	4-1/2 API Reg	4-1/2 API Reg	4-1/2 API Reg	6-5/8 API Reg	6-5/8 API Reg	6-5/8 API Reg
<b>Optional Components</b>								
Cut-Lipped Guide	<b>Logan Part No.</b>	<b>V6013</b>	<b>V6014</b>	<b>V6015</b>	<b>V6016</b>	<b>V6017</b>	<b>V6018</b>	<b>V6019</b>
	Bowen No.	32295	32305	32315	32335	32345	32355	32375
Mill Guide	<b>Logan Part No.</b>	<b>V6013</b>	<b>V6014</b>	<b>V6015</b>	<b>V6016</b>	<b>V6017</b>	<b>V6018</b>	<b>V6019</b>
	Bowen No.	32295	32305	32315	32335	32345	32355	32375
Adapter – 5/8" Sucker Rod	<b>Logan Part No.</b>	<b>V5011</b>	<b>V5014</b>	<b>V5014</b>	<b>V5014</b>	<b>V5017</b>	<b>V5017</b>	<b>V5017</b>
	Bowen No.	62254	62256	62256	62256	62258	62258	62258
Adapter – 3/4" Sucker Rod	<b>Logan Part No.</b>	<b>V7011</b>	<b>V7014</b>	<b>V7014</b>	<b>V7014</b>	<b>V7017</b>	<b>V7017</b>	<b>V7017</b>
	Bowen No.	62255	62257	62257	62257	62259	62259	62259
Keeper	<b>Logan Part No.</b>	<b>V9013</b>	<b>V9014</b>	<b>V9015</b>	<b>V9016</b>	<b>V9017</b>	<b>V9017</b>	<b>V9019</b>
	Bowen No.	66039	56181	66041	66044	66045	66045	66218

Innovex reserves the right to change or discontinue designs without prior notice.

Note: Guides left oversized are extra charge. Magnets shipped via air freight must include a Keeper.

**When ordering, please specify:**

Name and number of assembly

Size – OD

Top Connection – if other than standard

**Recommended Spare Parts:**

1 x Lipped Guide

1 x Mill Guide



**PRODUCT LINE**

Fishing & Intervention | Junk Catchers

**PRODUCT**

Fishing Magnets



		15	17	20				
Hole Size		14	16	19				
OD of Body		6-5/8 API	6-5/8 API	7-5/8 API				
Top Connection		Reg	Reg	Reg				
Approx. Pull in lbs		1,700 to 2,100	3,200 to 4,000	4,200 to 5,000				
<b>Complete Assembly</b>	<b>Logan Part No.</b>	<b>306-1400</b>	<b>306-1600</b>	<b>306-1900</b>				
	Bowen No.	32380	79183	79189				
Body	<b>Logan Part No.</b>	<b>V1020</b>	<b>V1021</b>	<b>V1022</b>				
	Bowen No.	32381	145730	79190				
Housing	<b>Logan Part No.</b>	<b>V2020</b>	<b>V2021</b>	<b>V2022</b>				
	Bowen No.	32382	145731	79191				
Pole Plate	<b>Logan Part No.</b>	<b>V3020</b>	<b>V3021</b>	<b>V3022</b>				
	Bowen No.	32383	145732	79192				
Magnetic Element	<b>Logan Part No.</b>	<b>V4020</b>	<b>V4020</b>	<b>V4022</b>				
	Bowen No.	32384	32384	79193				
Flush Guide	<b>Logan Part No.</b>	<b>V6020</b>	<b>V6021</b>	<b>V6022</b>				
	Bowen No.	32385	79188	79194				
Lifting Cap	<b>Logan Part No.</b>	<b>V8004</b>	<b>V8004</b>	<b>V8005</b>				
	Connection	6-5/8 API	6-5/8 API	7-5/8 API				
	Reg	Reg	Reg	Reg				
<b>Optional Components</b>								
Cut-Lipped Guide	<b>Logan Part No.</b>	<b>V6020</b>	<b>V6021</b>	<b>V6022</b>				
	Bowen No.	32385	79188	79194				
Mill Guide	<b>Logan Part No.</b>	<b>V6020</b>	<b>V6021</b>	<b>V6022</b>				
	Bowen No.	32385	79188	79194				
Adapter – 5/8" Sucker	<b>Logan Part No.</b>	<b>V5017</b>	-	-				
Rod	Bowen No.	62258	-	-				
Adapter – 3/4" Sucker	<b>Logan Part No.</b>	<b>V7017</b>	-	-				
Rod	Bowen No.	62259	-	-				
Keeper	<b>Logan Part No.</b>	<b>V9020</b>	<b>V9021</b>	<b>V9022</b>				
	Bowen No.	66219	145867	-				

Innovex reserves the right to change or discontinue designs without prior notice.

Note: Guides left oversized are extra charge. Magnets shipped via air freight must include a Keeper.

**When ordering, please specify:**

Name and number of assembly

Size – OD

Top Connection – if other than standard

**Recommended Spare Parts:**

1 x Lipped Guide

1 x Mill Guide

